

## ***POCKET DVR QUICK SET-UP GUIDE***

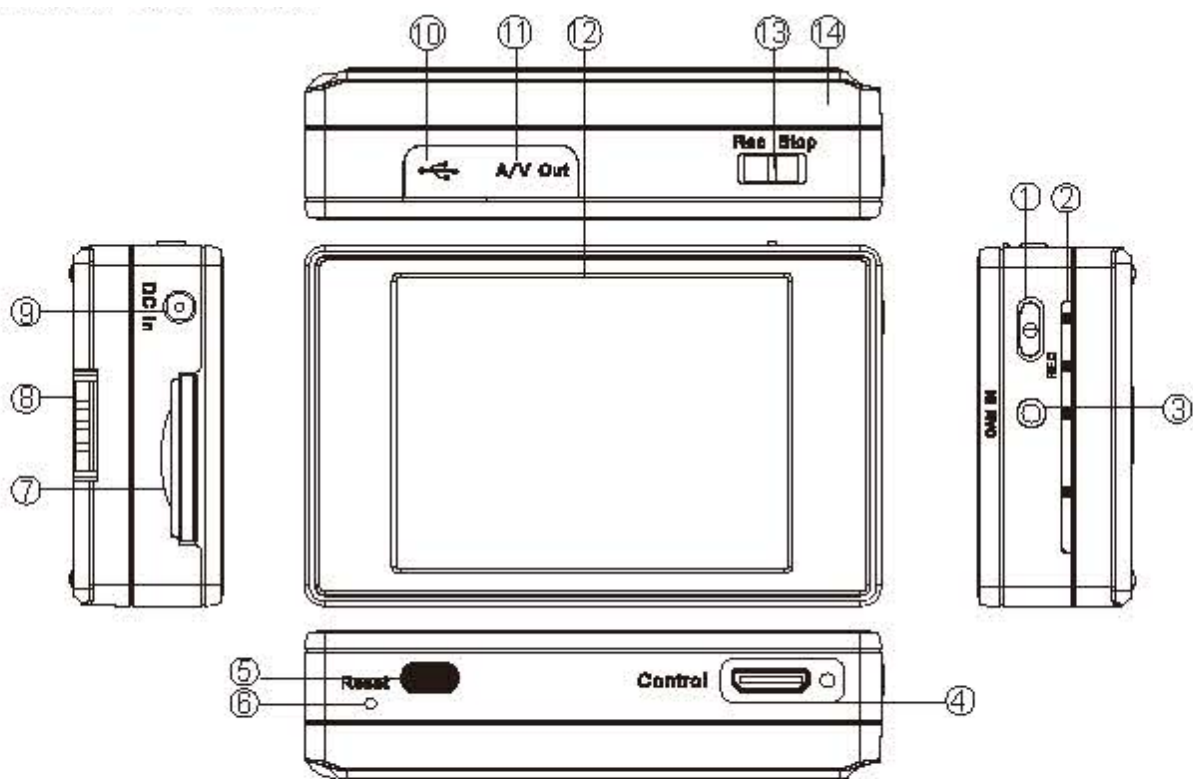

## ***PART IDENTIFICATION & NAMES:***



- 1. Power Button
- 2. Status Bar
- 3. Analog Cam In
- 4. Controller Port
- 5. Infrared Sensor

- 6. Reset Button
- 7. Memory Card Slot
- 8. Battery Lock Button
- 9. DC In Jack
- 10. USB Port

- 11. A/V Out Port
- 12. 3 Inch LCD Display
- 13. Record/Stop Button
- 14. Battery Pack

***SPECIFICATIONS:***

Display	
LCD	3 inch LCD
Resolution	
Video Resolution	VGA 640x480
Frame Rate	28 fps
TV Output	NTSC/PAL Adjustable
Support File Format	
Video	AVI、MPEG
Storage Format	FAT32、NTFS
Card Reader	SD、Micro SD
Remote Control	
Remote Controller	IR Remote Controller
Wire Controller	Power ON/OFF Wire Pilot Control
PC Interface	Mini USB 2.0
Miscellaneous	
Microphone	AGC Quality
File Geration Gap Time	3 sec.
Date/Time	YYYY/MM/DD, HH:MM:SS
Durability	
Storage Ratio	13 MB per min
Operation Time	CCD Camera: 200 min
	CMOS Camera: 250 min
Battery Life	200 min
Charging time	4.5 hour
Battery Type	Li-ion Battery: 2200mA/4400mA
Speaker	
S/N	>95 dB
Power	
Power Supply Voltage	DC 5V
Power Supply Current	Recording: 600 mA
	Playback: 480 mA
Physical	
Support Memory	SD and Micro SD
Dimension	85 X 55 X 17 mm
Weight	62 g

**IMPORTANT NOTE: Specifications Subject to Change Without Notice**



## ***BATTERY INSTALLATION:***

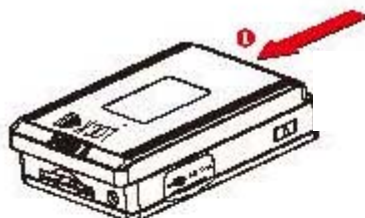

To remove the battery, gently push LOCK switch to right side and push battery in red arrow pointed direction.



To install the battery, gently push in red arrow pointed direction to secure battery and ensure that it is locked in the proper position.



Slide LOCK switch in red arrow pointed direction to lock battery onto device.

## ***BATTERY CHARGING:***

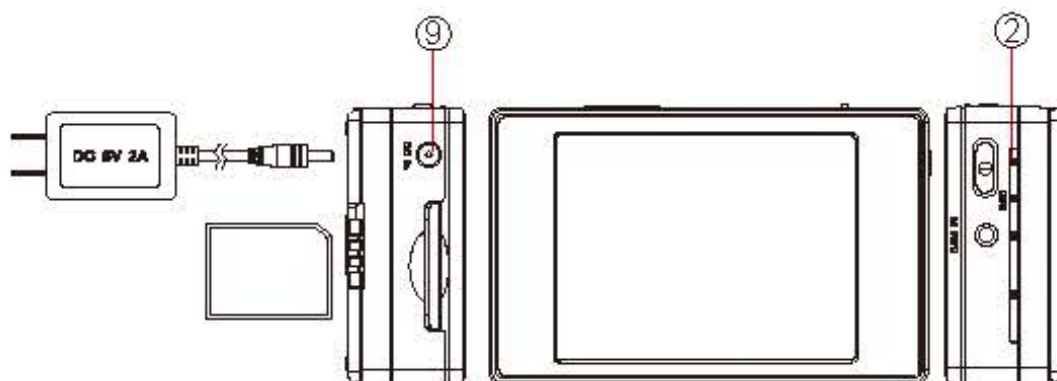

- 1.Plug charger into DC In port (9) on device.
- 2.PWR singals in red color (2) to show the device is charging.(3-4 hours)
- 3.After charging is completed, red color signal turns off automatically.

**CONNECTION ILLUSTRATION:**

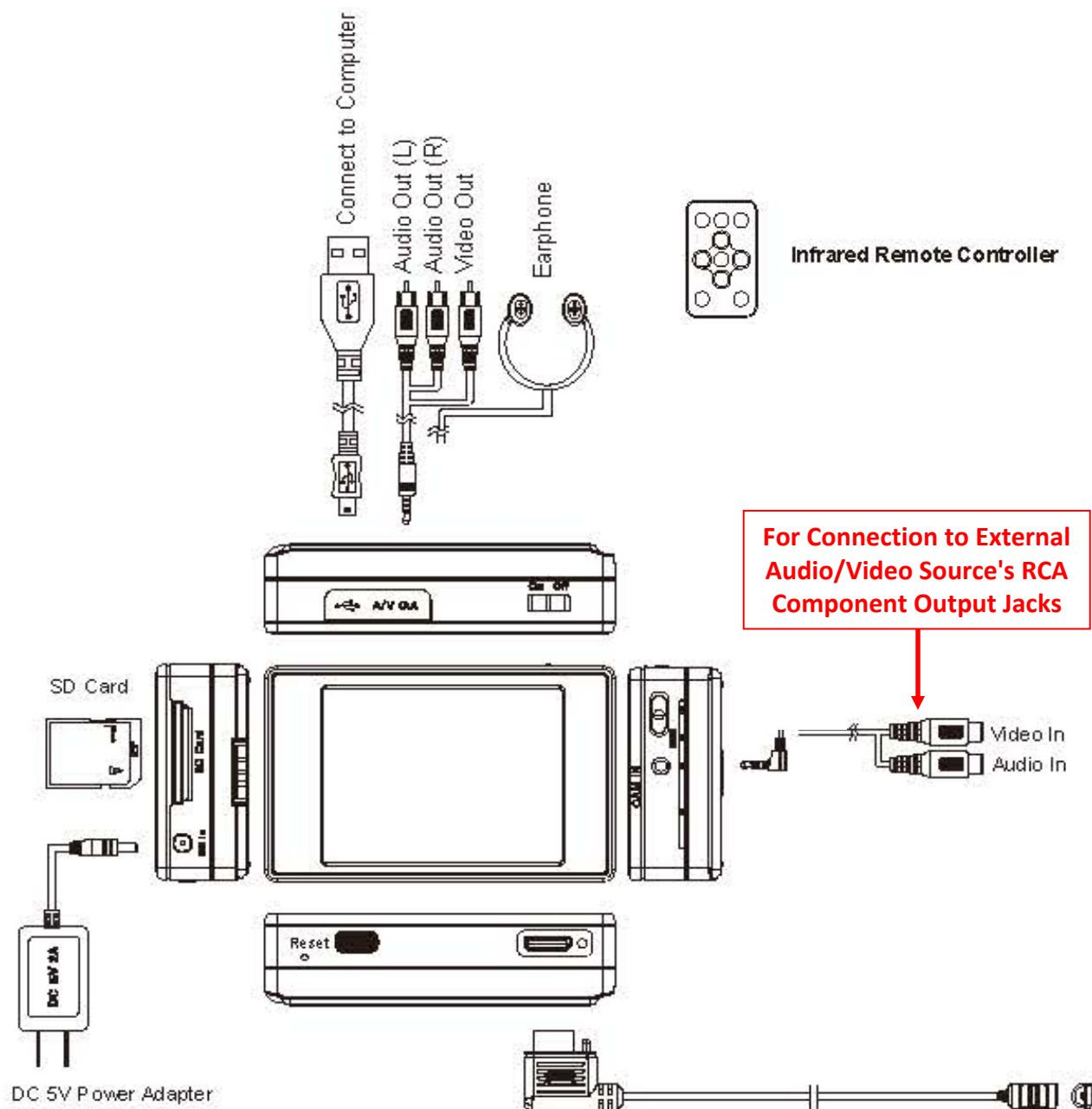

## ***VIDEO RECORDING RETRIVAL***

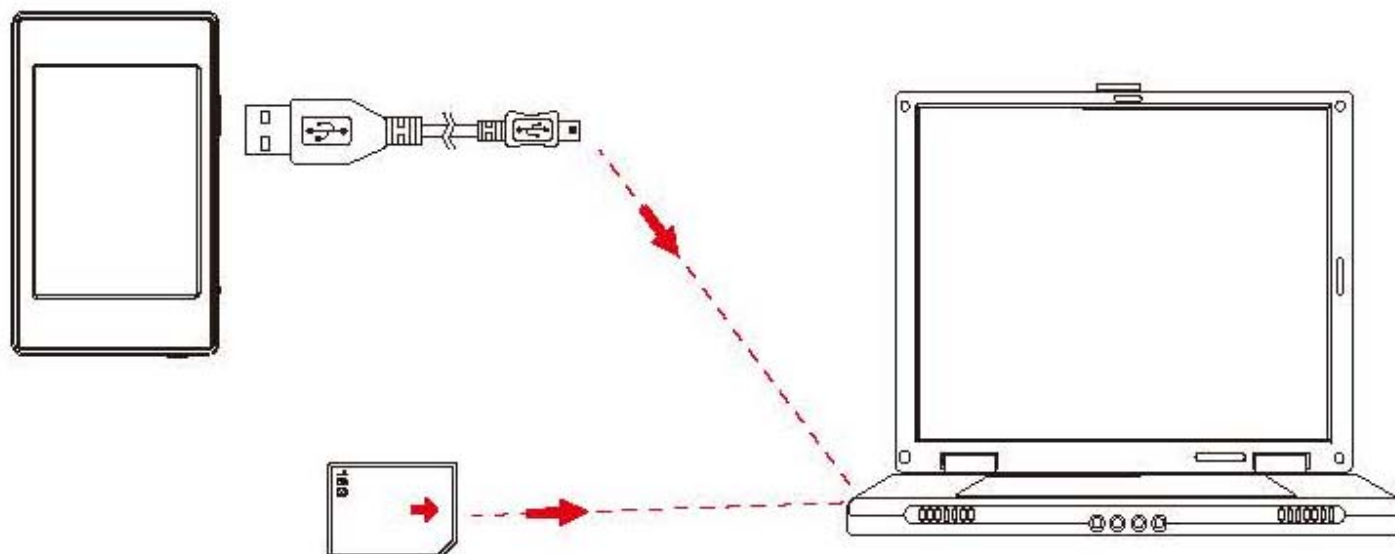

1. Video file is stored on the Memory card.
2. There are two methods to retrieve video files.
  - (1) Using USB Cable to connect to computer
  - (2) Using memory card reader to read and write from the folder directory
3. Computer detects the storage and user may browse and operate the storage, i.e., Rename, copy and paste, delete, duplicate, etc.



## ***USING IR REMOTE CONTROLLER & EDIT SETTINGS***

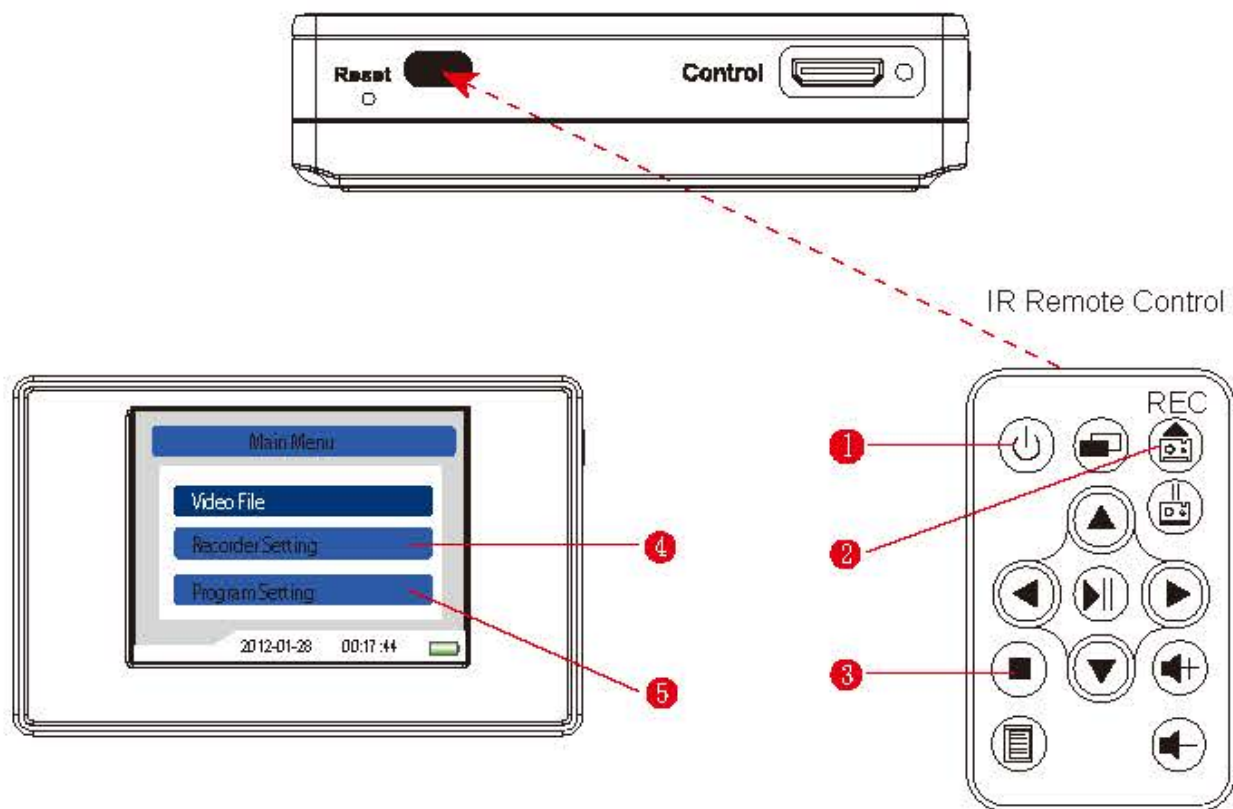

1. Turn on DVR before using IR remote control .
2. Aim IR Remote Controller at the sensor area to control device remotely.
3. Press Rec ② on the IR remote to start recording and press ③ to stop .
4. Press ③ again to return to Main Menu page.
6. Entering Recorder Setting ④ to turn on the Motion Detect.
7. Entering Program Setting ⑤ to edit the setting.
6. To turn off the DVR, press Power button ① .

**Note that the power button on IR remote control only serves to turn off the DVR.**